



# TINY HOMES *Expo Centre*

New Zealand's Biggest Tiny Homes Showyards



**NORDIC** Range

## EVA E 7.0m wide x 3.2m deep

**m<sup>2</sup>** 12.8m<sup>2</sup> Int Room + 8.6m<sup>2</sup> Veranda  
22.4m<sup>2</sup> External Footprint

Outstanding value timber garden rooms in a range of sizes with storage options and covered outdoor areas for entertaining. Choose from DIY or professional installation.

### Features

Internal Eaves Height	2.2m
Ridge Height	2.56m
Wall Thickness	44mm
Roof	27m <sup>2</sup> , 18mm ceiling boards
Floor	18mm floor boards, 28mm terrace boards
Door Opening Size	1.43m x 1.99m
Door Style	Double glazed, double sliding door
Number of Windows	3 opening windows, 0.71m x 1.52m
Glazing Material	Double glazing, 3mm real glass
Material	Slow grown Nordic Spruce, untreated
Additional Info	Treated foundation joists, wind braces, assembly kit, real glass in windows and doors, cylinder lock, product manual.

### PRICING & KITSET OPTIONS

<b>BASIC KITSET</b>	<b>\$21,990</b>
<b>DIY KITSET</b>	<b>\$27,270</b>
<b>FULLY BUILT</b>	<b>\$39,655</b>

### NO DEPOSIT FINANCE OVER 5 YEARS

**FROM ONLY \$188 per week\***

\*T&C's apply, see reverse



#### NO DEPOSIT FINANCE

Ask about our market leading finance package to spread the cost of your Tiny Home.



#### 5 YEAR WARRANTY

On materials, construction and components including gas and electrical certificates.

#### New Zealand's Best Tiny Homes Provider

Our company and products evolved from working within property, building and materials industries for decades. We believe in enabling Kiwi's to really *Start Living* by offering great service, great products and great prices. Just ask, we're here to help!



**GO TINY** *Start Living*

0800 447 261 | Silverdale | Mt Wellington | [gotinyhomes.nz](http://gotinyhomes.nz)

# EVA E 7.0m wide x 3.2m deep



## Pricing & Kitset Options (incl gst)

Kitset Components	Item Price	Basic Kitset	DIY Kitset	Fully Built
<b>EVA E - Flat Pack Kitset</b>	\$21,990	✓	✓	✓
Joist Foundation Pack	\$1,195		✓	✓
Skids / Bearers	\$695		✓	✓
Insulation Pack - Roof & Floor	\$795		✓	✓
Roof Cladding - Colorsteel®	\$2,595		✓	✓
<b>Professional Installation</b>				
Install Cabin, Joists & Roof	\$5,995			✓
Electrics Pack & Installation	\$2,595			✓
Exterior Paint / Oil	\$3,795			✓
<b>Delivery - location required</b>				
Delivery to nearest Mainfreight Depot	\$POA			
Hiab transport from Mainfreight Depot to site	\$POA			
<b>Total Price - Excluding Delivery</b>		<b>\$21,990</b>	<b>\$27,270</b>	<b>\$39,655</b>
<b>No Deposit Finance - From \$ Per Week</b>		n/a	n/a	<b>\$188</b>

## Eva E Floor Plan

m<sup>2</sup>
 12.8m<sup>2</sup> Int Room  
 8.6m<sup>2</sup> Veranda  
 22.4m<sup>2</sup> Ext Footprint

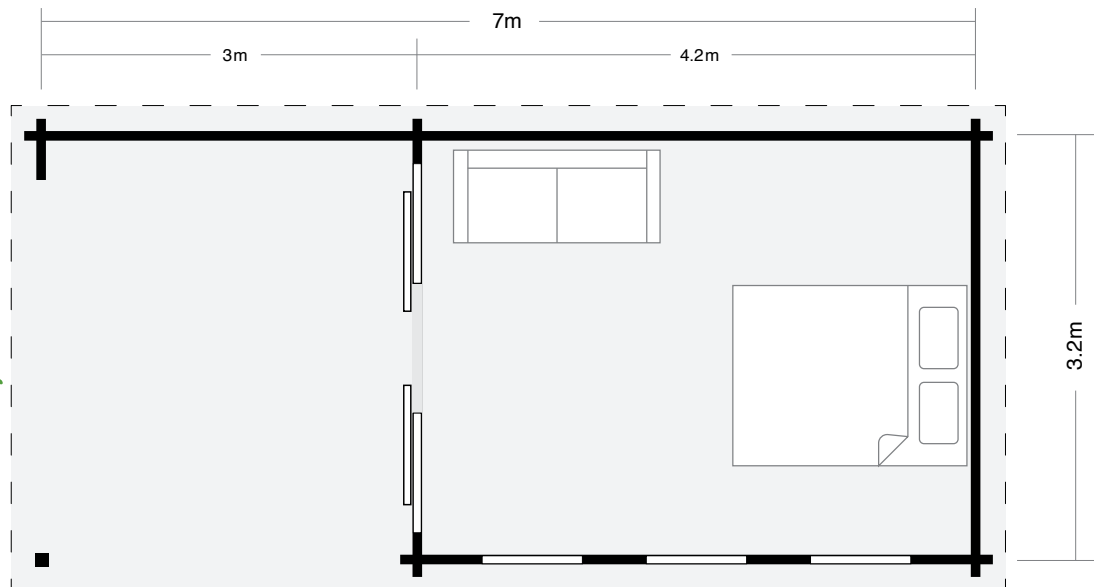

**GO TINY**  
*Start Living*



\*Finance rates shown are for approved purchasers who meet lending criteria. T&C's apply to finance and products. View online at [gotinyhomes.nz/terms](http://gotinyhomes.nz/terms)  
Floor plan drawing is not to scale. Furniture shown is for demonstration purposes only.

[www.gotinyhomes.nz](http://www.gotinyhomes.nz)



We're here to help, contact our experienced team about your tiny home dream!

**OPEN 7 DAYS**

Mon-Fri 9am-5pm  
Sat-Sun 10am-4pm

**SILVERDALE**

2 Silverdale Street  
Auckland 0932

**MT WELLINGTON**

500 Ellerslie Panmure Hwy  
Auckland 1060

**LET'S TALK**

0800 447 261  
[sales@gotinyhomes.nz](mailto:sales@gotinyhomes.nz)